

Putney Hill, SW15 1EZ

Approx Gross Internal Area = 73.31 sq m / 789 sq ft

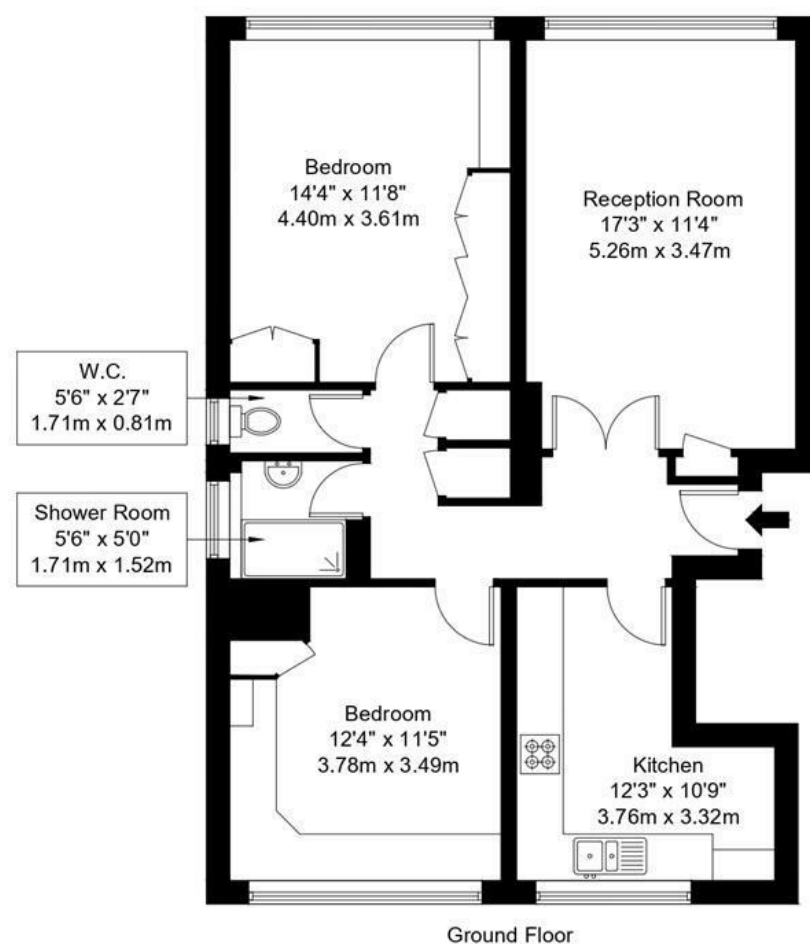
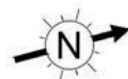

Ground Floor

Ref :

Copyright

**BLEU
PLAN**

The Floor plan is not to scale and measurements and areas shown are approximate and therefore should be used for illustrative purposes only. The plan has been prepared in accordance with the RICS code of Measuring Practice and whilst we have confidence in the information produced it must not be relied on. Maximum lengths and widths are represented on the floor plan. If there is any aspect of particular importance, you should carry out or commission your own inspection of the property.
Copyright @ BLEUPLAN

DISCLAIMER•These particulars are intended to give a fair and substantially correct overall description for the guidance of intending purchasers and do not constitute an offer or part of a contract. Prospective purchasers and/or lessees ought to seek their own professional advice.
•All descriptions, dimensions, areas, references to condition and necessary permissions for use and occupation and other details are given in good faith and are believed to be correct, but any intending purchasers should not rely on them as statements or representations of fact, but must satisfy themselves by inspection or otherwise as to the correctness of each of them.
•All measurements are approximate.



Putney Hill, London, SW15

In need of modernisation this ground floor apartment is situated just moments from Putney High Street and is offered with no onward chain.

Comprising two double bedrooms, kitchen with space for a table and chairs, reception room, bathroom and separate w.c. There are also communal gardens surrounding the development and residents parking to the front.

Fairlawns is located in Central Putney and is therefore just a short walk from both East Putney Underground Station and Putney Mainline Station as well as major bus links in to Central London.



- TWO DOUBLE BEDROOM APARTMENT
- LARGE RECEPTION ROOM
- BATHROOM
- OFF STREET PARKING
- KITCHEN
- SEPARATE WC
- COMMUNAL GARDENS
- CENTRAL PUTNEY LOCATION

Guide Price
£425,000
Available

